

Product specifications

Printer Specifications		SureColor SC-T3200/5200/7200 SureColor SC-T5200D/7200D		Scanner specifications		SureColor SC-T5200/7200 MFP SureColor SC-T5200D/7200D MFP	
Printhead		PrecisionCore™ TFP printhead		Scanner optical resolution		600dpi	
Printing Resolution		2,880 × 1,440dpi		Light source		Dual LED (RGB)	
Ink type		UltraChrome® XD aqueous pigment ink		Scanning method		CIS	
Colours		Magenta, Yellow, Cyan, Matte Black, Photo Black		Scan width		153mm to 914.4mm ¹³	
Ink cartridge size		110ml/350ml/700ml		Paper handling	Width	153mm to 965.2mm	
Maximum printing speed		28sec/A1 on plain paper			Thickness	0.05mm to 1.3mm	
Nozzle configuration		720 Nozzles per colour			Length	153mm to 2,438.4 mm ¹³	
Paper Handling	Roll paper replacement	Front access, spindle-less		Supported paper types		Plain Paper, Recycled paper, Tracing paper, Matte film, Blueprint copy, Matte paper for ink jet printers, Synthetic paper, Newspaper, Photo paper	
	Maximum media width	T3200: 24inch, T5200: 36inch, T7200: 44inch		Speed	Scan speed	Approx. 8.4cm/sec(200dpi)	
	Paper thickness	0.08mm-1.5mm Rigid board supported			Copy speed	Approx. .39sec/A1 ¹²	
Interface		USB2.0 1000/100/10Base-T		Scanning destination		Printer, or electronic file to: HDD (Option), shared folder, send by email (SMTP)	
RAM		1GB		Scanned file format		JPEG, PDF	
HDD		320GB (Optional)		Resolution	Scanning	200, 300, 360, 400, 600 dpi	
PostScript		Adobe® PostScript® 3™ Expansion Unit (Optional) ¹⁵			Copying	Scanning: 300dpi, Printing: 360 dpi	
Scanning functionality without PC		Supports scanner direct connection: Epson DS-6000(WW)/A3 and DS-6500(WW)/A4		Scanning accuracy		+/-0.2% of the specified vector length or +/-0.13mm (whichever the greater)	
Emulation		HP-GL/2, HP-RTL ¹⁴					
Power		Energy Star compliant					

Ink and consumables

UltraChrome XD Photo Black (110ml)	C13T692100
UltraChrome XD Cyan (110ml)	C13T692200
UltraChrome XD Magenta (110ml)	C13T692300
UltraChrome XD Yellow (110ml)	C13T692400
UltraChrome XD Matte Black (110ml)	C13T692500
UltraChrome XD Photo Black (350ml)	C13T693100
UltraChrome XD Cyan (350ml)	C13T693200
UltraChrome XD Magenta (350ml)	C13T693300
UltraChrome XD Yellow (350ml)	C13T693400
UltraChrome XD Matte Black (350ml)	C13T693500
UltraChrome XD Photo Black (700ml)	C13T694100
UltraChrome XD Cyan (700ml)	C13T694200
UltraChrome XD Magenta (700ml)	C13T694300
UltraChrome XD Yellow (700ml)	C13T694400
UltraChrome XD Matte Black (700ml)	C13T694500
Maintenance Box	C13T619300

Options

Adobe Postscript 3 Expansion Unit	C12C891131
Hard Disk Unit	C12C848031
MFP Scanner 36inch	C12C891071
MFP Scanner Stand 36inch	C12C844151
MFP Scanner Stand 44inch	C12C844161
Roll Media Adapter	C12C811401

What's in the box

Driver and utilities (CD)
User Guide (CD)
Setup Guide
Main unit
Power cable
Individual ink cartridges



¹ Copy and Scan speed is measured based on First Copy out SEF (Short Edge Feed). ² Maximum copy speed is measured based on First Copy out LEF (Long Edge Feed) Product specifications are subject to change without notice. ³ The actual maximum image width or length to be scanned is reduced by a default scanning margins of 3mm to all four directions. ⁴ HP-GL/2 and HP RTL are trademarks of Hewlett-Packard Company. Printer may not print HP-GL/2 or HP-RTL language data accurately depending on your system environment or type of print data use. In order to ensure correct printing results, please make sure that you run a printing test prior to deciding on purchasing the printer. Ask your local Epson representative or Epson authorised resellers for your test. ⁵ Adobe® and PostScript® 3™ are trademarks of Adobe Systems Incorporated in the United States and other countries.

To find out more visit www.epson.eu/cad

For further information please contact your local Epson office or visit www.epson-europe.com
Austria 01 253 49 78 333 **Belgium** +32 (0)2 792 04 47 **Czech** 800/142 052 **Denmark** 44 50 85 85 **Finland** 0201 552 091 **France** 09 74 75 04 04 (Cost of local call, operator charges may apply) **Germany** 030 300 190 573 **Greece** 210-8099499 **Hungary** 06800 147 83 **Ireland** 01 436 7742 **Italy** 02-660321 10 (0,12 € min) **Luxembourg** +352 27860692 **Middle East** +9714 8872172 **Netherlands** +31 (0)20 708 5099 **Norway** +47 67 11 37 00 **Poland** 0-0-800 4911299 (0,16 zł/min) **Portugal** 707 222 111 **Russia** (095) 777-03-55 **Slovakia** 0850 111 429 **South Africa** (+2711) 465-9621 **Spain** 93 582 15 00 **Sweden** 0771-400135 (Mobilsamtal – 0,99 kr/min, Lokala samtal – 0,30 kr/min, Utlandssamtal – 0,89 kr/min) **Switzerland** 022 592 7923 **Turkey** (0212) 3360303 **United Kingdom** 0871 222 6702

Trademarks and registered trademarks are the property of Seiko Epson Corporation or their respective owners. Product information is subject to change without prior notice.

SureColor SC-T3200, SC-T5200, SC-T7200
24-in, 36-in and 44-in production printers

INNOVATE, CREATE, PRINT



- CAD drawings
- Reprographics
- POS banners

ENGINEERED FOR PRINT

EPSON

EPSON
EXCEED YOUR VISION

DESIGNED FOR YOUR NEXT BIG PROJECT

PrecisionCore TFP PRINTHEAD

Epson's PrecisionCore printhead technology offers an unbeatable blend of speed and accuracy. In addition the permanent printhead guarantees no hidden cost, no unexpected downtime for head's end of life.



UltraChrome XD INKS

These pigmented inks print on glossy and matte paper, and are suitable for short-term outdoor use such as flag banners, construction fieldwork drawings and GIS material.



DOUBLE ROLL

The dual roll printer model allows you to change media rolls less frequently, increasing your productivity - especially during peak times. In addition, the printer automatically switches rolls according to the jobs being sent.



SPEED

Copy an A1 document in as little as 39 seconds in speed mode. Produce A1 prints in 28 seconds; these models have been designed to offer the productivity you need.



MULTIFUNCTION SOLUTION

Preserve every detail of documents and photographs with crisp, clear copies in both colour and monochrome.

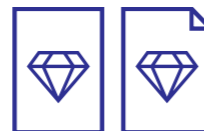

FAST COPY AND SCAN

Users can easily share their documents by using 'scan-to-folder', 'scan-to-email' or they can scan to other SC-T Series MFP solutions in the same network.

VERSATILITY

This all-purpose printer can handle line drawings through to vibrant posters with photographic images. It supports a variety of media, from economical uncoated paper to rigid boards for presentation or architectural models.

LOW TCO

Delivers a competitive cost per page with low ink consumption and cost reduction features. Allows printing only when the size matches the paper size option, and rotates image if necessary to reduce as much waste as possible.

POSTSCRIPT SUPPORT

All models have PostScript (PS) support as an option, which allows you to confidently print formats such as PDFs directly from programs.

FLEXIBLE AND EASY-TO-USE

These models are perfectly thought through to cut down operation time. It is fully operated from the front and has a spindle-less media holder. This means you have two separate flanges that can be easily put at the both end of a roll with a few clicks – no more struggling with a long spindle to be inserted in a wide roll. They also have a compact footprint saving precious space.

POWERFUL PROCESSOR AND 320GB HDD

This range has an optional 320GB HDD, offering a large amount of storage space and faster data processing thanks to a new processor and 1GB RAM.

ABSOLUTE SPEED ADVANTAGE**

COPYING AND SCANNING

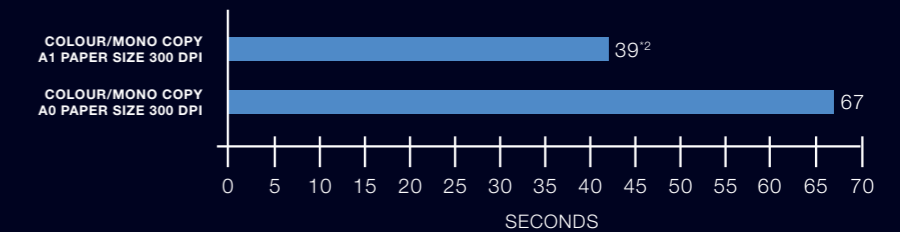
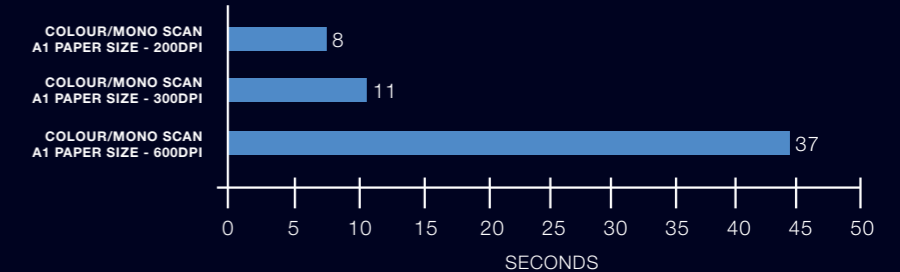

EXPERIENCE THE REAL ADVANTAGE OF THE POSTSCRIPT OPTION

SIMPLY DRAG AND DROP FILES TO PS FOLDERS, EVEN ENCRYPTED PDFS.

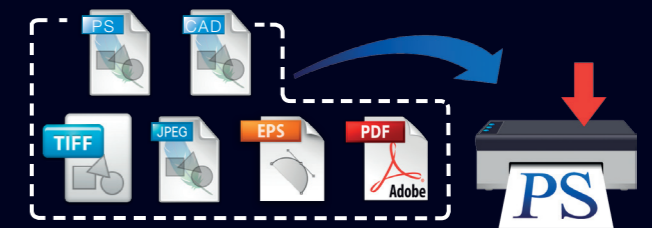

MAXIMISE YOUR PRODUCTIVITY WITH OUR HDD OPTION

MAKE THE MOST OUT OF YOUR MACHINE WITH OUR HDD OPTION

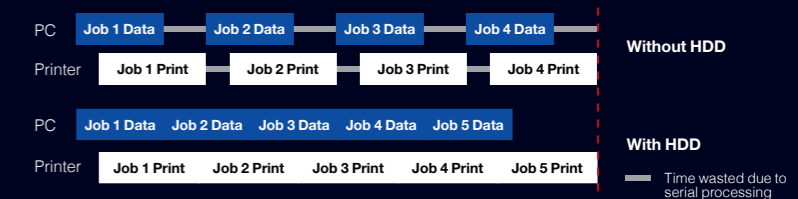



REPROGRAPHICS

Make colour copies of line drawings, blueprints or posters. Use the scanner to take digital copies of hand-drawn, hand-annotated or externally sourced analogue images and drawings.

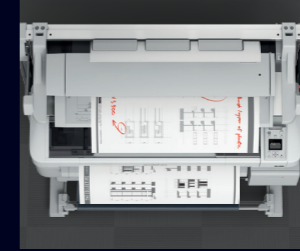

LARGE WORKGROUPS

The SC-T Series has all the tools needed to cater for the printing needs of large workgroups.



EDUCATION

Produce high-quality signage and posters for your school, academy or college, quickly and efficiently.



CAD/GIS

From line drawings to photo-realistic representations, prints are produced quickly and cost-effectively with high precision.



POS

Easily design POS posters for in-store promotions, advertisements and other messages. Achieve brilliant prints that are smudge, fade and water resistant on a wide range of materials.



TAILORED TO YOUR NEEDS

SC-T5200/SC-5200D

- 36-inch 4-color large-format printer
- Large ink cartridges of 110, 350 and 700 ml
- New built-in stacker (SC-T5200 only)
- Double roll (SC-T5200D only)
- 320GB HDD (optional)
- PostScript support with
- Dual Core 1.6GHz CPUs (optional)



SC-T7200/SC-7200D

- 44-inch 4-color large-format printer
- Large ink cartridges of 110, 350 and 700 ml
- New built-in stacker (SC-T7200 only)
- Double roll (SC-T7200D only)
- 320GB HDD (optional)
- PostScript support with
- Dual Core 1.6GHz CPUs (optional)



SC-T3200

- 24-inch 4-color large-format printer
- Large ink cartridges of 110, 350 and 700ml
- New built-in stacker
- 320GB HDD (optional)
- PostScript support with Dual Core 1.6GHz CPUs (optional)



SC-T5200 MFP/SC-T5200D MFP

- 36-inch 4-color large-format printer
- Large ink cartridges of 110, 350 and 700 ml
- Integrated 36-inch scanner
- Double roll (SC-T5200D MFP only)
- 320GB HDD (optional)
- PostScript support with Dual Core 1.6GHz CPUs (optional)



SC-T7200 MFP/SC-T7200D MFP

- 44-inch 4-color large-format printer
- Large ink cartridges of 110, 350 and 700 ml
- Integrated 36-inch scanner
- Double roll (SC-T7200D MFP only)
- 320GB HDD (optional)
- PostScript support with
- Dual Core 1.6GHz CPUs (optional)

